

FREESTANDING BORDER WALL

With Keystone Country Manor, you have the added option of building unreinforced freestanding walls to various plan geometry and limited heights. From low border walls, which define the edge of patios and decks to freestanding entry monuments, pilasters and parapets walls, Country Manor uses this interlocking geometry to achieve wider wall areas which provide strength and resistance to overturning forces.

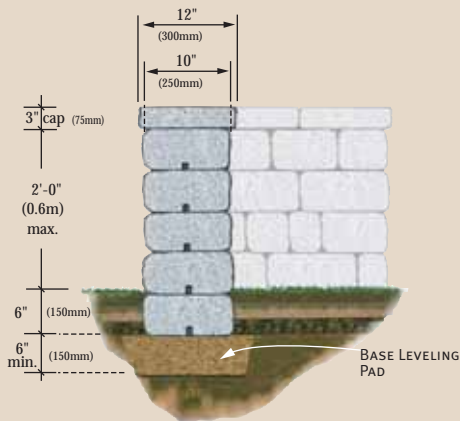

WALL END COLUMN

The wall end column is a larger version of the "Column Corner" detail. The benefit of this design option is the development of internal reinforcement to provide for greater strength and height, along with a larger footprint dimension for aesthetic purposes. Additionally, for markets where the 10"/8" unit is available, this can be combined with the 12"/10" unit to create a 20" long segment of the 30" x 30" column.

INTERNAL COLUMN REINFORCING SHOULD PROVIDE FOR STEEL RE-BAR AND SOLID CONCRETE GROUTING IN CONNECTION WITH A REINFORCED CONCRETE FOUNDATION.

OPTIONAL CAPPING PATTERN

CUT CAPS TO FIT AGAINST PERPENDICULAR SURFACE

3" UNIVERSAL CAP

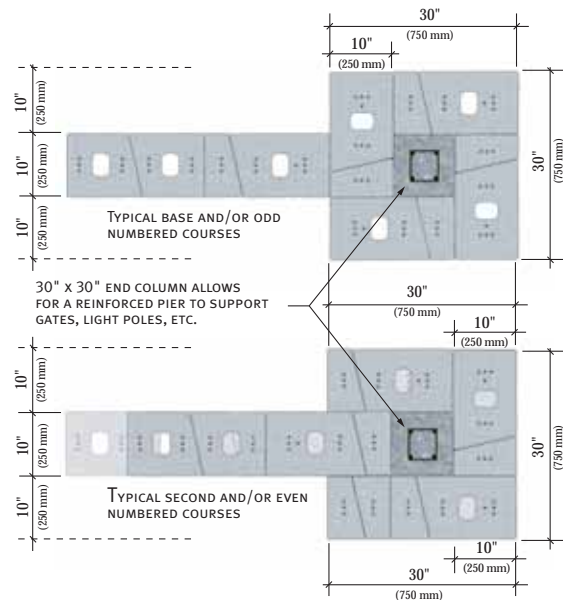
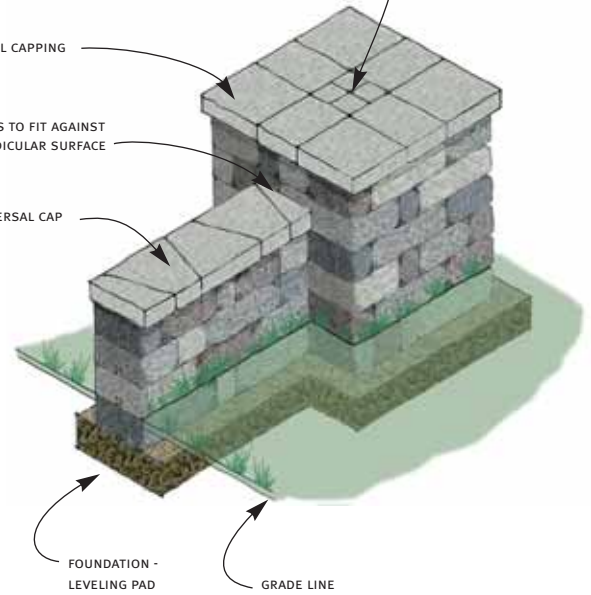

DESIGN DETAILS

WALL OFFSET

- ▶ Wider wall geometry (footprint) provides greater strength for parapet walls to resist overturning.
- ▶ Offsets allow for graceful changes in wall direction.
- ▶ Offsets are an opportunity for aesthetic geometry and landscape feature areas.

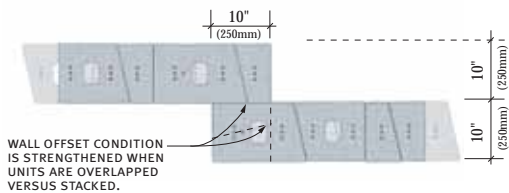
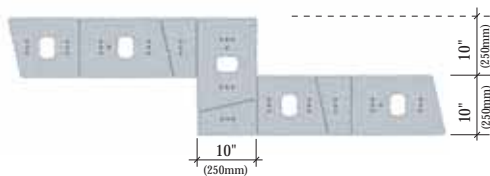
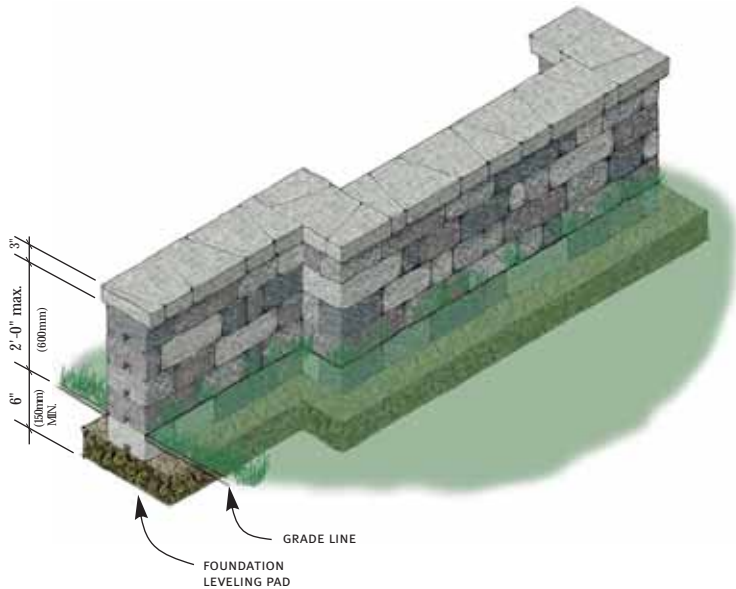

Notes:

- (1.) The minimum offset for two parallel walls as shown in the details on this page, is 10". Continuous offsets @ maximum 10'-0" O.C. will provide strength at parapet walls in coordination with construction adhesive (Keystone Kapseal™) and/or vertical reinforcement as required by engineer.
- (2.) It is important to use overlapping unit combinations at the offset location where two units combined together equal 20" in length (see plan geometry below).
- (3.) Details showing freestanding wall applications show partial sections of walls. The unfinished ends, with channel openings visible, are not meant to portray a finished condition.



"L" RETURN END

Similar to column corners, this detail offers stability and strength to resist overturning forces at the end of a freestanding wall.

